

Viking Blast Helmet



Design Features:

- Designed and manufactured in accordance with AS/NZ1716-2003
- Rigid ABS thermoplastic outer shell for high impact resistance
- Light 3kg design for less operator fatigue
- Molded shape evenly disperses incoming airflow around the operators head, face and neck
- Durable nylon outer cape with removable inner neck band
- Molded inner polystyrene cap fitted with foam padding
- Sound absorbing inner foam reduces incoming airflow noise to less than 80dBa
- Sound deadening hose supplied as standard
- Replacement outer visors available in packs of 20
- Replacement inner visors available in packs of 100

Optional Items

- Incoming airflow regulator
- Air conditioner to cool incoming air supply
- Leather outer cape for greater durability when using metallic abrasives

Assemblies

- Viking Helmet C/W Inner & Outer Cape (Weight 3.00 kg (6.61 lbs))

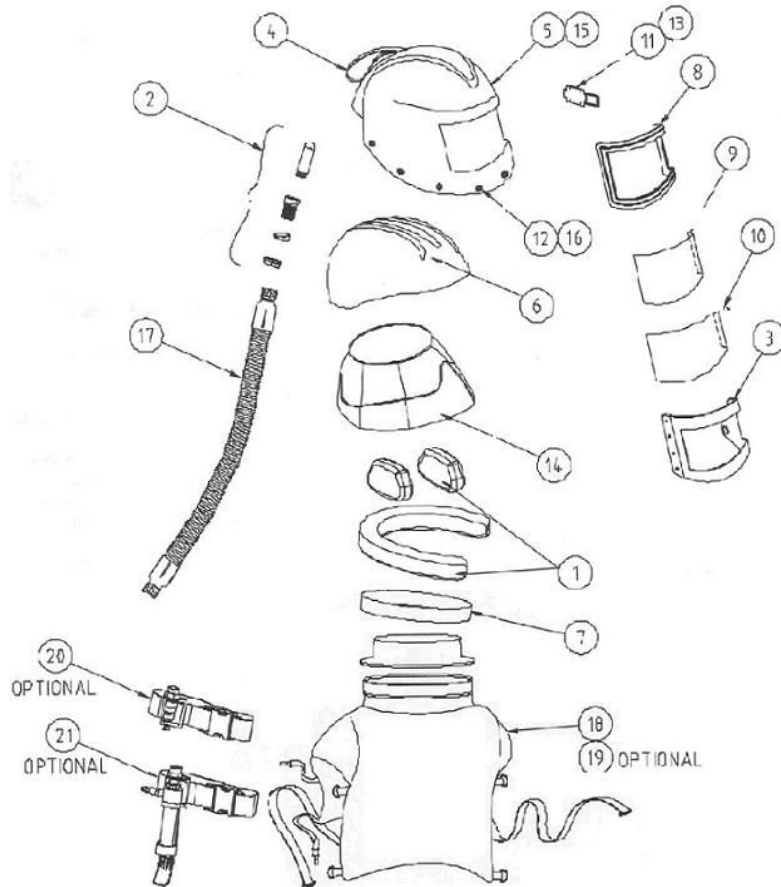

Components

- Inner Paddin Kit
- Air Entry Assembly
- Window Frame Assembly
- Strap Handle Assembly
- Helmet Shell
- Inner Shell Liner
- Sealing Band
- Inner Window Seal
- Inner Visor (pkt 20)
- Outer Visor (pkt 100)
- Latch TL800B
- Press Studs
- Pop Rivet – dome HD Dia. 3.2 x 9.5 LG x 6.4mm Grip (Alum)
- Sponge Inner Insert
- Titan II Label
- Pop Rivet –Dome HD Dia. 4 x 10.3 LG x 6.4mm Grip (Alum)
- Sound Deadening hose
- Inner & Outer Cape
- Cape-Leather (optional)
- Air Regulator & Belt (optional)
- Air Conditioner & Belt (optional)
- Inner Padding Kit (Weight 0.12 kg (0.26 lbs))
- Air Entry Assembly (Weight 0.06 kg (0.13 lbs))
- Window Frame Assembly (Weight 0.10 kg (0.22 lbs))
- Strap Handle Assembly (Weight 0.10 kg (0.22 lbs))

Codes

- (6)
- (2) **HEL-VIK AIRCON**
- (3) **HEL-VIK FRAME**

- (5)
- (14)
- (7)
- (8) **HEL-VIK SEAL**
- (9) **HEL-VIK INNER**
- (10) **HEL-VIK OUTER**
- (11)

- (12)
- (1) **HEL-VIK HOSE**
- (16)
- (17) **HEL-VIK HOSE**
- (18-19) **HEL-VIK CAPE**
- (18-19)
- (20) **HEL-VIK REGU**
- (21)