

Blast Helmet

Nova 2000 Blast Helmet

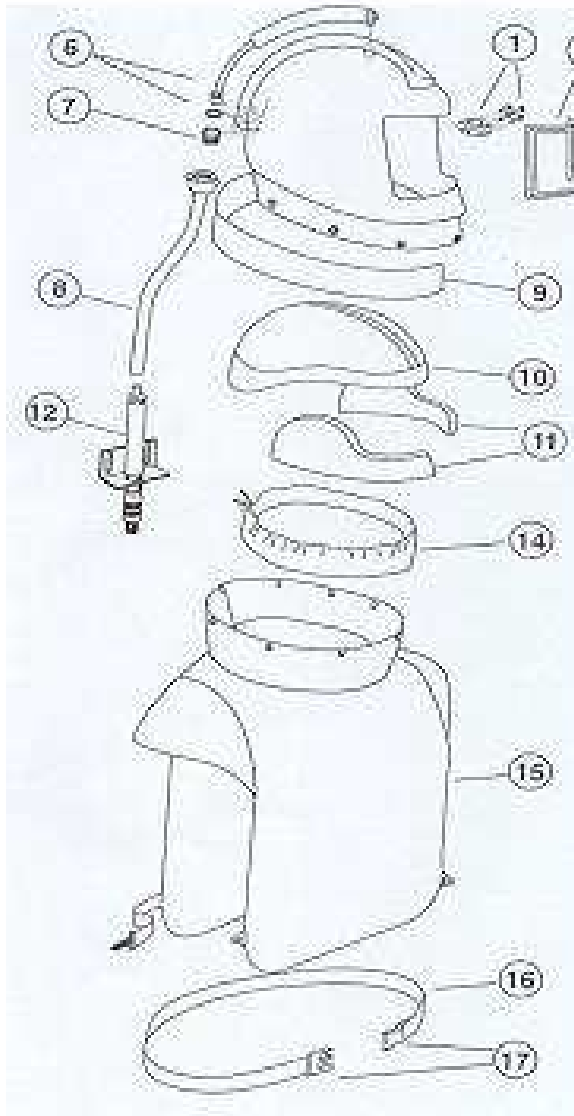

Item	Description	Code No.
-	Nova 2000 Blast helmet, with air control valve, complete	Nova-2000
-	Nova 2000 Blast Helmet, Less air control valve, complete	Nova-2000s
1	Face Frame Latch (includes 4 screws & nuts)	NV2008
2	Rubber Face Frame Gasket	NV2003
3	Inner Lens AS/NZ 1337:1992	NV2018
4	Outer Lens	NV2019
5	Face Frame complete with hinge and lens locating lugs (includes 3 screws and nuts)	NV2004
6	Internal Air Hose & Silencer Hosetail and washer	NV2005
7	Reducing Bush	NV2007
8a	Fitted Helmet Supply Hose & Belt Holder	NV2021NS
8b	Fitted Helmet supply hose for air conditioner	NV2021S
9	Cape Cover band	NV2013
10	Polystyrene Head Done	NV2009
11	Side wings (pair)	NV2010
12	Air Control Valve	NV2016
14	Inner Bib for Cape	NV2012
15	Nylon Cape Complete with Inner Bib	NV2002
	Leather Cape Complete with inner Bib	NV2002L
16	Belt with buckles	NV2022
17	Belt Buckles	NV2020

© Syntech Distributors Ltd, April 2005